

Model

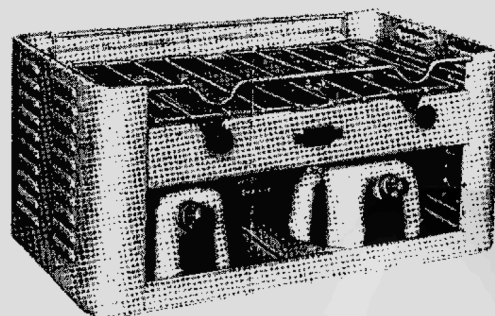

No. 348

**How to Operate
and Service your**

Coleman

INSTANT-LIGHTING

Model No. 348

**ALCOHOL
MARINE STOVE**

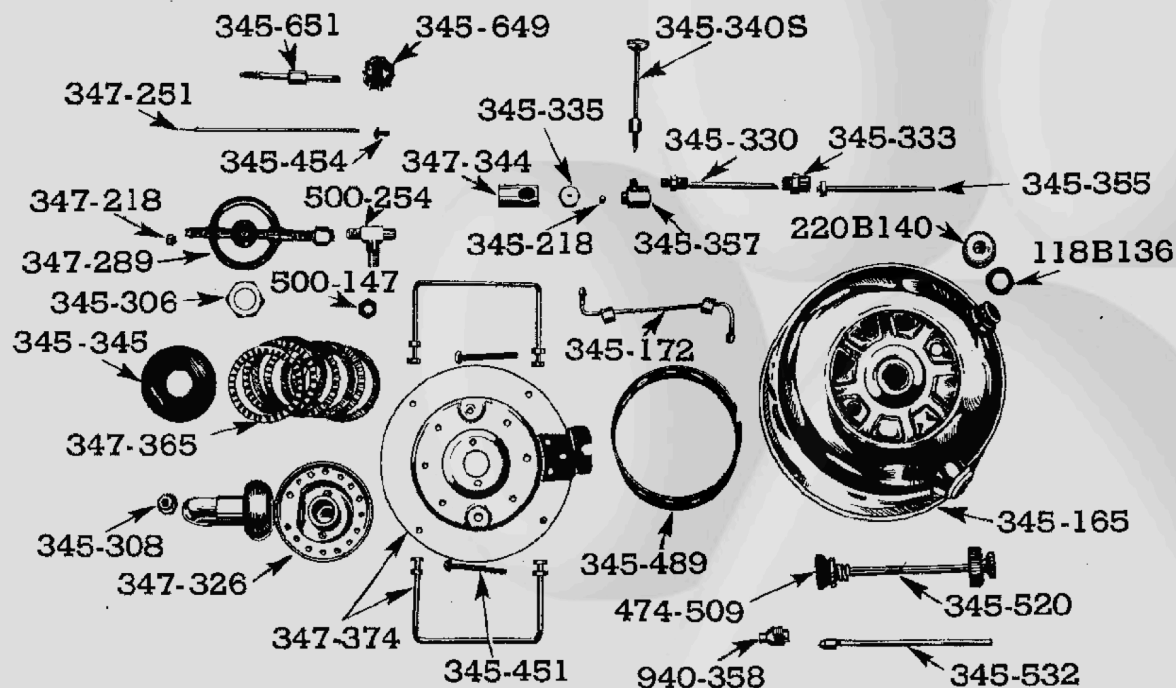

To obtain satisfactory results,
read and follow these instructions carefully
step by step

| Order By Number | Name of Part |
|--------------------|---------------------------------------|
| 118B136 | Filler Plug Gasket |
| 220B140 | Filler Plug Complete |
| 345-165 | Flount Complete |
| 345-172 | Feed Wire Assembly |
| 345-218 | Preheater Gas Tip |
| 345-306 | Burner Cap Nut |
| 345-308 | Drain Cap |
| 345-330 | Outlet Nipple and Feed Tube |
| 345-333 | Preheat Connecting Nipple |
| 345-335 | Fuel Tip Cap |
| 345-340S | Preheater Valve Stem Assembly |
| 345-345 | Burner Cap and Pins |
| 345-355 | Mixing Disc and Tube |
| 345-357 | Preheater Valve Body |
| 345-360 | Preheater Complete |
| 345-434 | Grate |
| 345-451 | 10-24x2" Rd. Hd. Brass Machine Screw |
| 345-454 | 4-36x3/8" Rd. Hd. Brass Machine Screw |

| Order By Number | Name of Part |
|--------------------|---------------------------------------|
| 345-489 | Burner Base Rest |
| 345-520 | Pump Plunger Complete (Less Air Stem) |
| 345-532 | Air Stem |
| 345-649 | Generator Wheel and Bushing |
| 345-651 | Valve Stem |
| 347-218 | Gas Tip |
| 347-251 | Cleaner Rod and Needle |
| 347-262 | Generator Complete |
| 347-289 | Generator Renewal Parts |
| 347-326 | Burner Manifold |
| 347-344 | Hot Blast Tube |
| 347-365 | Burner Ring (Set of Six) |
| 347-374 | Burner Baffle and Locators Assembly |
| 474-509 | Pump Leather |
| 500-147 | Lock Nut |
| 500-254 | Generator Valve Body |
| 940-358 | Check Valve |

Made in United States of America

General Office and Factory: WICHITA 1, KANSAS, U. S. A.
Canadian Office and Factory: Toronto, Canada
Sales Offices: Philadelphia 8; San Francisco 3; Los Angeles 1;
Honolulu, Hawaii

F1429A

Printed in U. S. A.

HOW TO USE YOUR MARINE STOVE

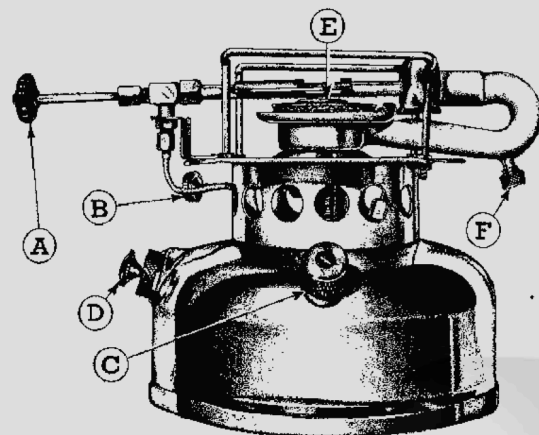

PROPER FUEL

To obtain satisfactory performance from your No. 348 Marine Stove and longer life for the generator, always use fresh, clean ALCOHOL. Keep the supply fresh, clean, and in a metal container.

1. Turn latch at top of stove to release grates. Raise grates so fount and burner may be lifted out.

2. To Fill Fount

Turn generator valve (A) and preheater valve (B) to right; make sure they are closed firmly. Remove filler plug (C). Have fount in a level position, then fill it with fresh, clean alcohol. Fount holds three pints. Replace filler plug and tighten firmly with fingers.

3. To Pump

Turn pump plunger (D) two full turns to the left. Place thumb over hole in pump plunger (D), pump 25-35 full strokes. Remove thumb; turn pump plunger to the right until tight. This screws the air stem back into check valve at

bottom of pump barrel and provides a positive shut off at that point.

4. To Light

While holding a lighted match against generator at blast tube opening (E), slowly open preheater valve (B) two complete turns. Pump more air pressure into the fount in order to maintain a hot blue blast flame under the generator. Allow preheater to operate for approximately one minute, then open generator valve stem (A). As soon as burner lights from preheater flame, close preheater valve (B). Flame regulation is obtained by turning generator valve stem to left or right.

If burner lights with a yellow smoky flame then you perhaps have not preheated it sufficiently. If yellow flame doesn't clear up quickly, then close valve and drain manifold after removing drain cap (F) and start over again. Should flame have a tendency to float away from burner then you may have over preheated the generator. Just continue to hold lighted match above burner and flame will soon settle down.

5. To Turn Off

Turn generator valve wheel (A) to right until closed firmly. The flame will go out in a few seconds. It is not necessary to release pressure from the fount.

6. To Install Generator Parts

Release pressure from fount by loosening filler plug. Unscrew feed wire jamb nut from bottom of valve body. Tap wire lightly to loosen it. Loosen jamb nut which holds generator valve body to frame. Remove and disassemble generator. Hold the No. 347-251 needle with a pair of pliers while you screw valve stem into it. When you install the No. 347-287 generator tube, be sure to turn it so the flame spreader will be on top and parallel to the burner cap.

KEEP BURNER PARTS clean. An obstruction, such as a burned match head, near fillers in cap, will produce a yellow flame at that point.

YOU MAY ADD pressure to the fount while the stove is in operation. Increasing the air pressure in the fount will increase the force or efficiency of the flame. Oil the pump leather occasionally to keep it in good order.

IF PREHEATER should fail entirely, then disassemble and clean it by washing the parts in clean fuel. Force air through the openings, but do not use a needle or any other metal instrument for in so doing you might enlarge the orifice in some part and thus damage it beyond further use. To get off the preheater remove the two bolts or screws which hold the frame to fount. Then notice carefully each step taken in disassembling so that you will not have any difficulty in reassembling.

KEEP FOUNT CLEAN by rinsing it occasionally with clean fuel. Pour and shake the contents out through the filler plug bushing.

IF STOVE IS to be stored for any length of time be sure to empty the founts.

THE STOVE GENERATOR is merely a device for vaporizing or changing the liquid fuel to a vapor. Eventually the generator may fill up with carbon to the extent that no more fuel may be forced through it. It would be well, therefore, to keep an extra generator renewal package No. 345-289 on hand for a spare.

THE USE OF A GOOD quality of clean, fresh alcohol will of course increase the length of service obtained from each generator.

CONTACT your dealer when you need service assistance or parts for your stove. If necessary write to The Coleman Company, Inc.